

# Illustrated Index

## Torque Converter Housing

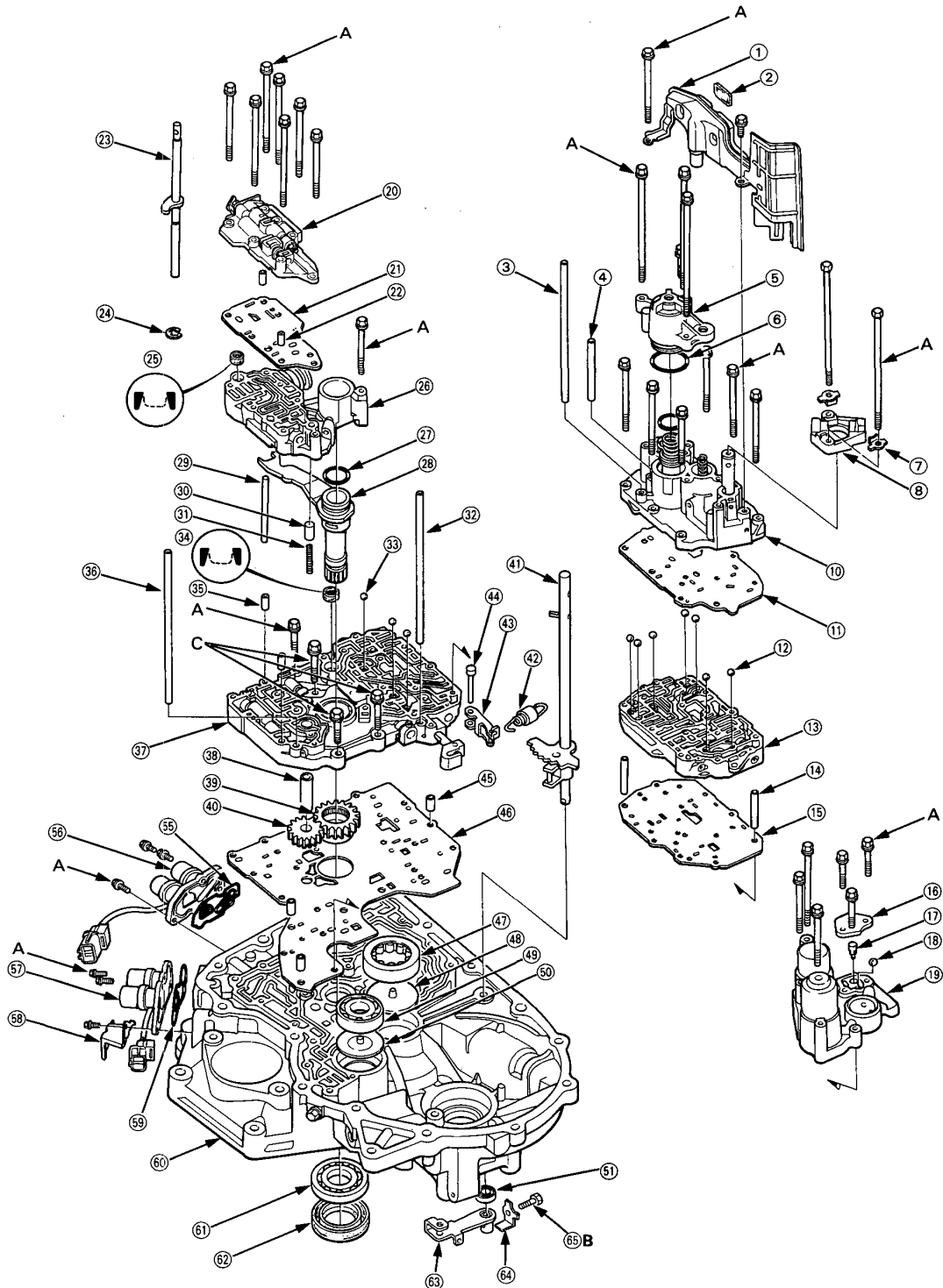



- ① ATF STRAINER
- ② MAGNET
- ③ OIL FEED PIPE
- ④ OIL FEED PIPE
- ⑤ 4TH ACCUMULATOR COVER
- ⑥ O-RING Replace.
- ⑦ LOCK WASHER Replace.
- ⑧ SERVO DETENT BASE
- ⑨ DOWEL PIN
- ⑩ SERVO BODY
- ⑪ SERVO SEPARATOR PLATE
- ⑫ CHECK BALL
- ⑬ SECONDARY VALVE BODY
- ⑭ DOWEL PIN
- ⑮ SECONDARY SEPARATOR PLATE
- ⑯ ACCUMULATOR BODY COVER
- ⑰ 1ST ACCUMULATOR CHOKE
- ⑱ STEEL BALL
- ⑲ 1ST/2ND ACCUMULATOR BODY
- ⑳ THROTTLE VALVE BODY
- ㉑ THROTTLE SEPARATOR PLATE
- ㉒ DOWEL PIN
- ㉓ THROTTLE CONTROL SHAFT
- ㉔ E RING Replace.
- ㉕ FILTER Replace.
- ㉖ REGULATOR VALVE BODY
- ㉗ O-RING Replace.
- ㉘ STATOR SHAFT
- ㉙ STOPPER SHAFT
- ㉚ TORQUE CONVERTER CHECK VALVE
- ㉛ TORQUE CONVERTER CHECK VALVE SPRING

- ㉜ OIL FEED PIPE
- ㉝ CHECK BALL
- ㉞ FILTER Replace.
- ㉟ DOWEL PIN
- ㊱ OIL FEED PIPE
- ㊲ MAIN VALVE BODY
- ㊳ OIL PUMP DRIVEN GEAR SHAFT
- ㊴ OIL PUMP DRIVE GEAR
- ㊵ OIL PUMP DRIVEN GEAR
- ㊶ CONTROL SHAFT
- ㊷ DETENT SPRING
- ㊸ DETENT ARM
- ㊹ DETENT ARM SHAFT
- ㊺ DOWEL PIN
- ㊻ MAIN SEPARATOR PLATE
- ㊼ COUNTERSHAFT NEEDLE BEARING
- ㊽ OIL GUIDE PLATE Replace.
- ㊾ SECONDARY SHAFT BALL BEARING
- ㊿ OIL GUIDE PLATE Replace.
- ① OIL SEAL Replace.
- ② SHIFT CONTROL SOLENOID FILTER/GASKET Replace.
- ③ SHIFT CONTROL SOLENOID VALVE ASSEMBLY
- ④ LOCK-UP CONTROL SOLENOID VALVE ASSEMBLY
- ⑤ CONECTOR HOLDER
- ⑥ LOCK-UP CONTROL SOLENOID FILTER/GASKET Replace.
- ⑦ TORQUE CONVERTER HOUSING
- ⑧ MAINSHAFT BALL BEARING
- ⑨ OIL SEAL Replace.
- ⑩ CONTROL LEVER
- ⑪ LOCK WASHER Replace.
- ⑫ LOCK BOLT

#### TORQUE SPECIFICATIONS

Ref No.	Torque Value	Bolt Size	Remarks
A	12 N·m (1.2 kg-m, 9 lb-ft)	6 × 1.0 mm	
B	14 N·m (1.4 kg-m, 10 lb-ft)	6 × 1.0 mm	
C	18 N·m (1.8 kg-m, 13 lb-ft)	8 × 1.25 mm	